

ADDENDUM NO. 01
SUWANNEE PRIMARY SCHOOL COVERED PLAY STRUCTURE
and
I.T &TRANSPORTATION BUILDING (SHELL STRUCTURE)
for the
SCHOOL BOARD OF SUWANNEE COUNTY
A/E# 2012.51A & 2013.46A

DATE: February 4, 2014

TO: All Interested Contractors

FROM: Architects RZK, Inc.

1.0 PRE-BID CONFERENCE

- A. A non-mandatory pre-bid conference was held on Thursday, January 30, 2014. Attached herewith is a copy of the sign-in sheet.

1.1 BID DATE AND TIME

- A. The bid date is **Tuesday, February 11, 2014, and the bids are to be delivered on or before 2:00 pm (EST) at Suwannee County Schools (main office) located at 702 2nd Street NW, Live Oak, FL 32064.**

1.2 MODIFICATIONS OR ADJUSTMENTS

The following modifications are in response to the questions or concerns that became apparent at the pre-bid or thereafter.

- A. **TESTING:** The owner (SCSB) will be responsible for testing concrete delivered to the site and field fabricated items to ensure the concrete and structures comply with all requirements. The contractor will thereafter be responsible for any subsequent testing of same the replacement of same to confirm it complies with all requirements. See below for compaction testing.
- B. **CONTRACTOR QUALIFICATION FORMS:** In lieu of that specified under section 6 of the INSTRUCTIONS TO BIDDERS, insert that these forms will be requested from one or more of the apparent low bidders and will be used in conjunction with other information to determine if the bidder is the lowest responsible firm to undertake the work.
- C. **SITE PLAN:** A formal site plan is not available at this time; however, attached is a preliminary plan which shows the slab elevation and location of utilities (for information only). The site work will be performed by the SCSB maintenance staff, by a separate contractor or may be considered as additional work for the lowest responsible bidder. The site will be rough graded to the slab bottom elevation by the SCSB and the low bidder will be responsible for the compaction thereof and notifying the owner's testing company to undertake testing and issue

test reports. The contractor may begin work on the slab, foundations and under slab utilities and shall assure appropriate compaction is obtained and confirmed via testing on all disturbed locations in the area of the work prior to pouring any concrete.

- D. SIDEWALK at COVERED PLAY:** The contractor shall provide a 4 inch thick concrete sidewalk to the covered play structure as shown on the cover page for those drawings. The walk shall be 6 feet wide, reinforced with appropriate welded wire fabric and shall have a 7 ¼ inch deep thickened edge on each side reinforced with a #4 rebar which is discontinuous at expansion joints located every 20 feet on center maximum. The walk shall have control saw cut joints at 5 feet on center between the expansion joints.
- E. METAL BUILDING MANUFACTURER:** Basis of design includes products which can be provided by AMERICAN BUILDINGS COMPANY Eufaula, Alabama web site www.americanbuildings.com. Other manufacturers with equivalent national or southeastern exposure having a ten (10) year history of manufacturing pre-engineered metal buildings, provided their products are equal in all aspects including the specified warranty requirements, are acceptable for bid.
- F. LIGHTNING PROTECTION:** Lightning protection is NOT to be included in this bid effort on either of the structures.
- G. GALVANIZED STEEL FRAMING:** Galvanized steel framing (main frame and purlins) shall NOT be included in this bid effort on either of the structures. The main frame and purlins for the COVERED PLAY are to be primed and painted since it will be exposed to the elements. The TRANSPORTATION building main frame and purlins are to be factory primed and some of the components will be field painted during the fit out which will be bid in the future.
- H. WINDOWS:** All windows are to be the projected type with a top hinge and the bottom edge projecting outwards.

Please enter the appropriate addendum number on the proposal form to be submitted.

ARCHITECTS RZK, INC.



John C. Zwick, Architect, LEED AP

attachments:

- Pre Bid Conference Sign-Up Sheets (2 pages)
- COVERED PLAY STRUCTURE LOCATION (8-1/2 x 11 size)
- IT & TRANSPORTATION BUILDING – SITE SKETCH (8-1/2 X 11 size)

SIGN IN SHEET FOR PRE-BID MEETING

BID #14-201

SUWANNEE PRIMARY SCHOOL COVERED PLAY STRUCTURE and TRANSPORTATION & I.T. SHELL STRUCTURE

JANUARY 30, 2014 AT 10:30 AM

REPRESENTATIVE NAME	COMPANY NAME	PHONE NUMBER AND/OR EMAIL ADDRESS
Mark A. Carver	Suw. District Schools	386-647-4151 MCarver@Suwannee.k12.fl.us
Willie Robinson	Cathey Construction	850-648-5100 INFO@CatheyConstruction.com
Peter Poulos	ANGLIN CONSTRUCTION	352-376-4089 Peter@anglin-cfca.com
Mike Walsh	Parrish - McCall Constructors	352-328-1571 mwalshe@parrish-mccall.com
JEFF LASZA	" " " " " " "	JLASZA@PARRISH-MCCALL.com
Larry Paterson	NEFEC Building Code Serv.	382-745-1832 patersonl@nefec.org
JOHN ZWICK	ARCHITECTS RZK, INC.	321-631-8039 john.zwick@architects.rzk.com
Kevin Bedenbaugh	Plumb-level Const. Co.	386-792-4061 Plumblevelconstruction@gmail.com
RJ Williams	Gamble & Asso. Const	386-364-1234 RalphJWilliams@windstream.net
Luke McInnis	McInnis Services LLC	386-935-0014 luke@lmcsteel.com
Matt Denson	Union Lasteel Metal Buildings	386-496-0681 mdenson@unionlasteel.com
Donald Music	Music Construction	386-658-1598 musicconstruction@windstream.net
Robert Ogles	Ogles Construction	386-364-4838 OGLES.CONSTRUCTION@GMAIL.COM

SIGN IN SHEET FOR PRE-BID MEETING

BID #14-201

SUWANNEE PRIMARY SCHOOL COVERED PLAY STRUCTURE and TRANSPORTATION & I.T. SHELL STRUCTURE

JANUARY 30, 2014 AT 10:30 AM

REPRESENTATIVE NAME

COMPANY NAME

PHONE NUMBER AND/OR EMAIL ADDRESS

Tim Alcorn

J. Sherrman Frier & Assoc.

386-364-8124 TIMALCORN@WINDSTARFLA.NET

Brent McCall

McCall Construction LLC

386-364-5924 btmccall@gmail.com

DOMENIC SCORPIO

D.E. SCORPIO CORP.

352-363-6070 DOMENIC@DESCORPIOCORP.COM

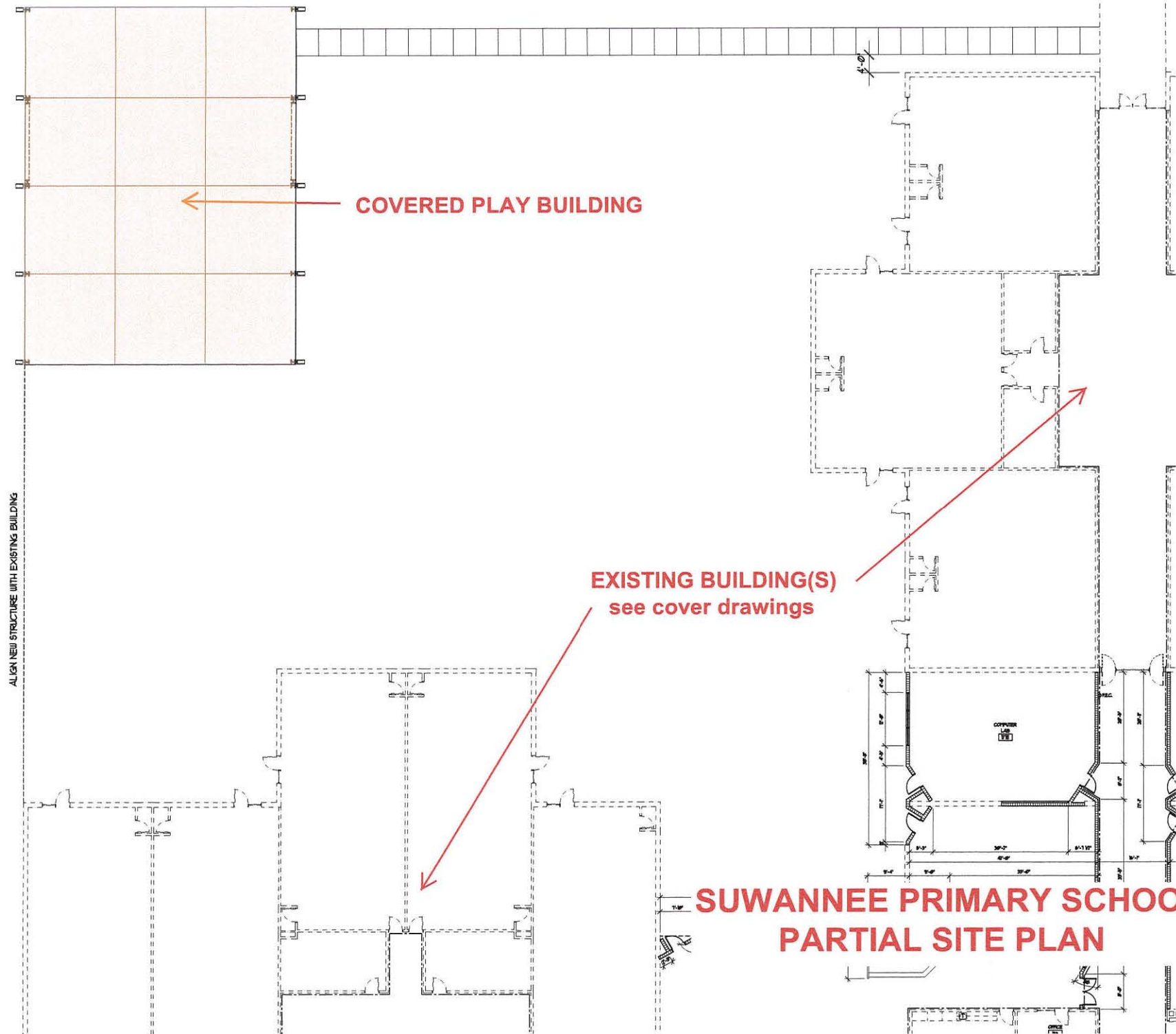

This plan is to be used by the contractor for the finish floor elevation. The utilities and other data are shown for information such that the contractor is aware of the proposed future site work for coordination of his efforts to accommodate same.

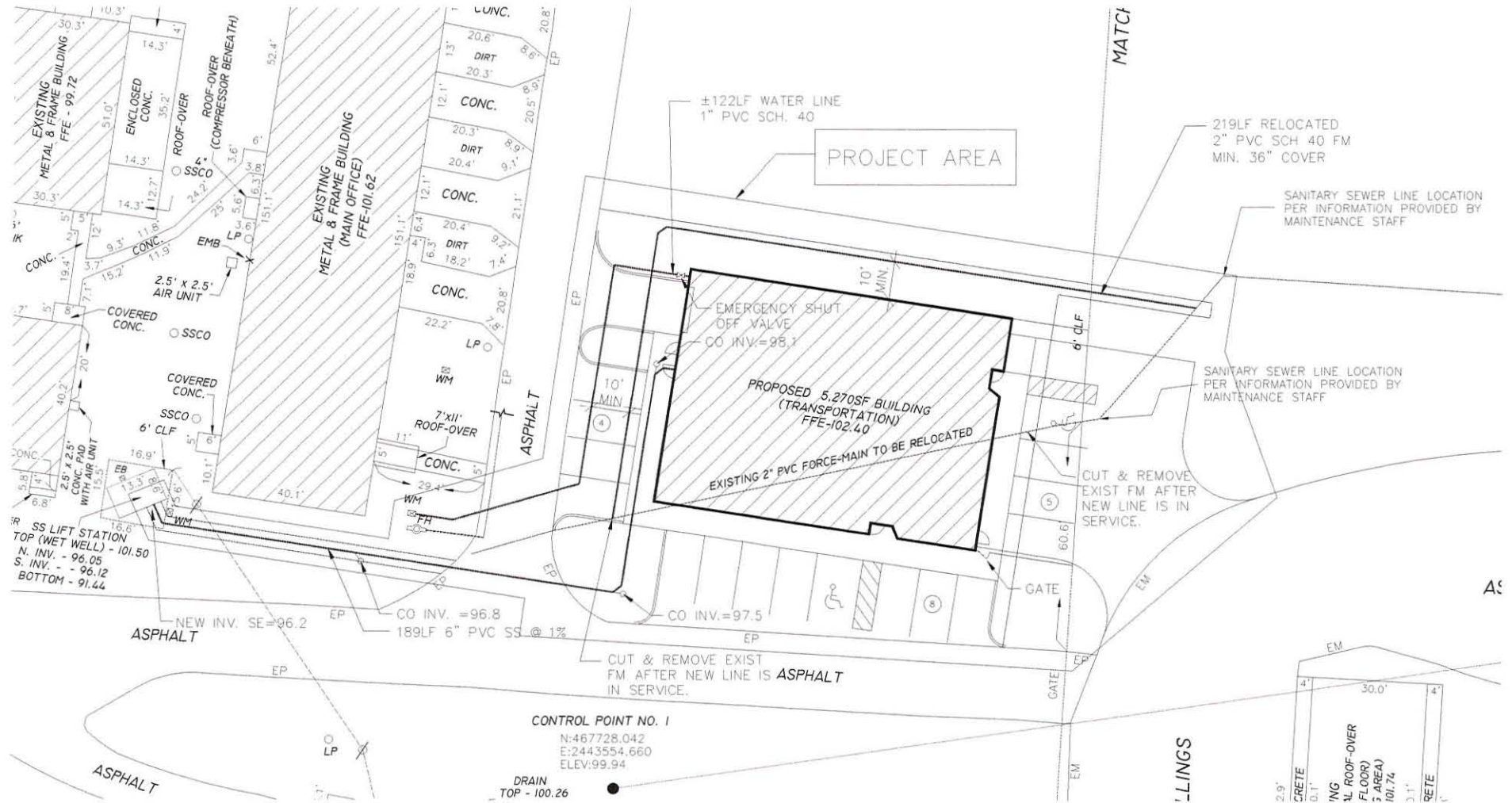

IT & TRANSPORTATION BUILDING - SITE SKETCH

1" = 40' +/-

Dated 02.04.14